

**STOVAX**  
*Fire Your Imagination*



**RIVA** | **STUDIO**

# Expert Retailer Network

We take great care to ensure that our fires are designed, tested and manufactured to the highest possible quality and safety standards. We are just as concerned to make certain that they are sold and installed correctly so that you enjoy years of pleasure from your purchase.

Accordingly, you will find our products are only available from experienced, independent retailers who will be happy to show you a selection of models locally in their showrooms, often fully operational. These independent retailers will discuss your individual requirements both technical (such as sizing the heat output to your room and advising on your flue type) and visual; and ensure that you select the most appropriate product for your home. They will also be able to advise on, or assist, with the installation process as well as help provide any after-sales support and servicing your appliance may require in the future.

Whilst we encourage our retailers to promote fireplace products and their outlets via the internet, we do not believe suitable levels of customer care and satisfaction can be obtained from nationwide online sales and we would strongly recommend that you consider this when undertaking your research and making a purchasing decision. Further, please be aware that we do not offer technical support (beyond our statutory responsibilities) to products bought via nationwide online sales, where this support would normally be offered by one of our qualified, independent retailers.

**STOVAX**  
*Fire Your Imagination*



Studio 2 Freestanding on 140 Low Bench  
with gloss black enamelled flue pipe.

# RIVA | STUDIO

## Innovation & Inspiration

The fireplace is the heart of your home, a centrepiece to which friends and family gather and an opportunity for you to express your own individual design tastes. The Riva Studio range of cassette and freestanding fires has been designed to create a striking feature in your living space with their enticing widescreen flame visuals complemented by an extensive array of frames and styling options. The pure, simplistic form of the Riva Studio belies the high levels of engineering and technical innovation that keeps this range not only at the forefront of twenty first century fire design, but also exceptional heating performance and controllability.

## Woodburning

All Riva Studio models are designed for woodburning only. Wood is an environmentally friendly fuel; when burnt, the carbon dioxide released into the atmosphere is approximately the same as that absorbed by the tree during growth. It is also a renewable resource, particularly when derived from plantations and cultivated woodland.



For optimum results, we recommend logs should be seasoned for 2 years or more to achieve a moisture content below 20%. This will not only give twice the output of freshly felled timber but will also help to avoid a build up of tar in your flue. Furthermore, if you can obtain hardwood logs this is better still, as they will have a greatly increased calorific value compared to softwoods.



## Contents

### Cassette Fires

Riva Studio Profil.....	10 - 11
Riva Studio Ceramica Wave .....	12 - 13
Riva Studio Edge .....	14 - 15
Riva Studio Edge + .....	16 - 17
Riva Studio Glass.....	18 - 19
Riva Studio Steel.....	20 - 21
Riva Studio Verve.....	22 - 23
Riva Studio Bauhaus.....	24 - 25
Riva Studio Firenze, Pienza & Sienna .....	26 - 27

### Hearth Mounted Fires

Riva Studio Sorrento .....	28 - 29
----------------------------	---------

### Bench Mounted Fires

Riva Studio Bench Glass & Steel.....	30 - 31
--------------------------------------	---------

### Freestanding Fires

Riva Studio 500 .....	32 - 33
Riva Studio 1 .....	34 - 35
Riva Studio 2.....	36 - 37
Riva Studio 3.....	38 - 39

### Technical Information

Fire Information.....	40
Frame Information.....	41 - 43
Further Information .....	44 - 47



## High Efficiency Cassette & Freestanding Fires

Stovax's dedication to the development of premium quality stoves and fireplaces over the past 30 years has helped to make it one

of Europe's leading specialist manufacturers. Now the company's expertise has brought woodburning technology to the very pinnacle of performance and design with the Riva Studio range of fireplaces.



Expertly designed, the Riva Studio's clean, contemporary lines complement modern interiors and incorporate Stovax's technically advanced cleanburn combustion systems, which provide outstanding flame pictures and superior heating efficiencies, powerful airwash systems to help keep the window clean and the facility for practical options such as fan-assisted convection and multi-space heating.

To own a Riva Studio is to make a design statement that will become a heart-warming focal point to your home. There are several different styling options from the simple Edge or Cool Wall kits to the larger format Steel, Glass or Ceramic frames, there are even several Freestanding, Bench mounted & Hearth mounted models to ensure that there will be a Riva Studio just right for you.

Just as importantly, by burning logs, the Riva Studio fires use an energy source that is carbon neutral, renewable and infinitely better for our environment.

## Key Design Features



Stovax Riva Studio fires feature the very latest cleanburn combustion systems, allowing them to burn logs with outstanding efficiency, resulting in more heat delivery into the room and less going up the chimney.

This technological advancement is achieved by introducing preheated, secondary air into the firebox to burn the excess hydrocarbons in the smoke. Airwash air flow also helps keep the window clean, allowing you to enjoy the flames to the full. The Riva Studio offers you full control of flame aesthetics. From a lazy roll to a lively roar, you can adjust your fire to suit your mood. The doors on the Studio 500, 1 and 2 are hinged to the left whilst the larger Studio 3 doors open downwards, minimising the risk of ash falling beyond the hearth and into the room.

### Riva Studio design features

1. TCL (Technical Combustion Lining)  
High density thermal liner system
2. Heated air jets from cleanburn ports burn hydrocarbons in smoke
3. Airwash air flow
4. Primary control
5. Removable handle (Studio 500, 1, 2 & 3)  
and door opening catch (Studio 500, 1 & 2)
6. Convected and radiant heat
7. Convected heat ducting system outlet
8. Easy fit flue connection
9. Removable baffles
10. External air facility (cassettes only)
11. Optional fan kit (cassettes only)
12. Optional 10° flue outlet (cassettes only - not illustrated)
13. Optional Smoke Control Kit (Studio 500†, 1 & 2 only - not illustrated)

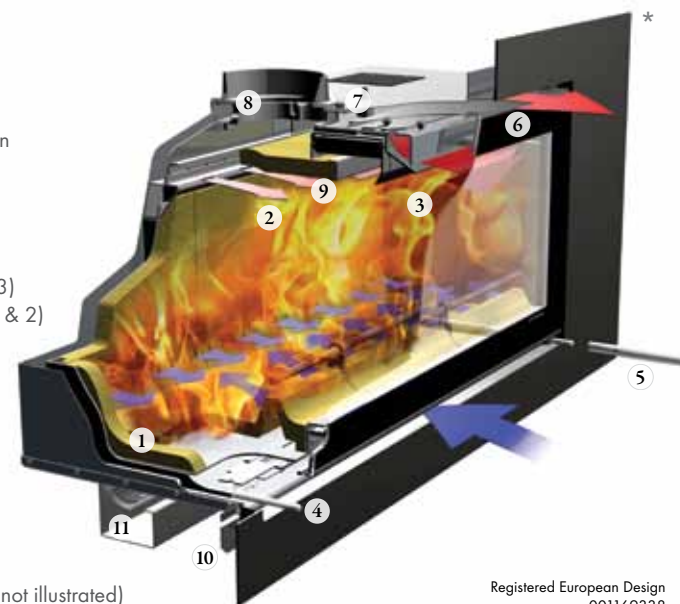

Registered European Design  
001169338

\* Illustration shows cassette fire with frame.

† The Riva Studio 500 cassette & Freestanding's suitability for use in Smoke Control Areas is subject to official listing.



## Smoke Control Area Approved

Many town and city homes are located in Smoke Control Areas as designated by the Clean Air Act 1993. The Riva Studio 500\*, 1 and 2 cassette and freestanding fires, when fitted with the appropriate kit, have been approved for the burning of wood in these areas meaning that even the most urban of homes can benefit from this environmentally friendly fuel source.

*\*subject to official listing*



## Product Warranty

When you choose a Stovax Riva Studio cassette or freestanding fire, quality and technology are assured. Accordingly, your Stovax retailer will provide you with a Two Year Warranty for your new Riva Studio cassette or freestanding fire. Full details of this warranty are available to view at [www.stovax.com](http://www.stovax.com).



## Fireplace Tile Surrounds

Stovax has designed a unique collection of 35 porcelain and natural stone tiles to complement your Riva Studio installation and these can be seen on several images throughout this brochure. Our fireplace tiles are the perfect enhancement, creating the ultimate contemporary look and adding further tonal and textural interest to a room. Whether you choose to set off your Studio with contrasting colours or add to your existing palette, there are many possibilities and ways to ensure your Riva Studio is perfectly suited to your home and decorative tastes.



Riva Studio 2 Profil shown with Parisian White 60 x 30cm Fireplace Tile Surround.

# RIVA | STUDIO CASSETTE SIZE OPTIONS

Riva Studio cassettes are available in four sizes, each with a wide variety of frame options. From glass and steel to ceramic and stone, there will be a frame to suit your own personal taste and style. Alternatively the Studio can be fitted with an Edge kit for a more minimalist appearance. This brochure is organised by frame style - but your first decision is to identify the correct Studio size and heat output for your room, and then select the frame style to suit your home.

	Studio 500	Studio 1	Studio 2	Studio 3
Heat Outputs	5.0kW	5.0kW	8.0kW	11.0kW
Dimensions mm (wxhxd)*	555x415x350	745x415x350	950x440x350	1332x450x393
Max. log length	250mm (10")	300mm (12")	400mm (16")	500mm (20")

\* Firebox dimensions

## RIVA | STUDIO 500



## RIVA | STUDIO 1



**Top:**

Riva Studio 500 Edge +  
in Jet Black Metallic.

**Bottom:**

Riva Studio 1 Profil  
in Jet Black Metallic.

### Key features for all Studio sizes

- High efficiency – up to 80%
- Boost setting for lighting and re-fueling
- Removable steel and TCL baffles
- TCL firebox lining
- Radiant heat and convected heat
- External air facility (cassette only)
- Optional fan-assisted convection system (cassette only)
- Optional warm air ducting system
- Top flue connection (internal Ø) - 153mm (6")
- Suitable for Smoke Control Areas\*

### Riva Studio Cassette Options:

Fireplace Tile Surround Packages.....	Please see page 5
External air kit .....	RVS-AIR
Studio 500 Fan-assisted convection kit (240v).....	RVS-500FAN
Studio 1 Fan-assisted convection kit (240v).....	RVS-SFAN
Studio 2/3 Fan-assisted convection kit (240v).....	RVS-LFAN
Warm air ducting kit** .....	8572
10° angled flue outlet** .....	RVS-CA7589
Smoke Control Kit Studio 500 <sup>Δ</sup> .....	RVS-500SCKIT
Smoke Control Kit Studio 1 .....	RVS-1SCKIT
Smoke Control Kit Studio 2 .....	RVS-2SCKIT

\* Sizes 500, 1 and 2 only. When fitted with a Smoke Control Kit and used in accordance with the operating instructions.

\*\* Please see page 47 for further details

<sup>Δ</sup> The suitability of the Riva Studio 500 is subject to official listing.

#### Top

Riva Studio 2 Bauhaus  
in Jet Black Metallic.

#### Bottom:

Riva Studio 3 Edge  
'Cool Wall'.

## RIVA | STUDIO 2



## RIVA | STUDIO 3



# RIVA | STUDIO STYLING OPTIONS

These pages outline the many different frame options available for the Riva Studio fires., all of which are shown in detail throughout the brochure. From the frameless Edge to the impressive Verve, these frame options have all been designed specifically to complement the visuals of the Riva Studio cassette and offer you a spectrum of different styles and materials. There are even Freestanding, Bench mounted and Hearth mounted versions so you can be sure to find a fire that will be perfect for your home, making your Riva Studio a focal point that the whole family will warm to.

## Riva Studio Coloured Frame Options



For those who want to add a splash of colour to their living space, the Riva Studio Profil, Bauhaus, Verve and Steel frames are also available in four eye-catching colours: Metallic Red, Metallic Blue, Metallic Bronze and Ivory. For full details, please see page 42 - 43.

## Riva Studio Visualiser iPad App



To aid you with your fire selection, why not download the Stovax Riva Studio Visualiser app for your iPad? Convenient and easy to use, the app gives you a visual concept of having a real Riva Studio in your room. Please see page 46 for further information.

Styling Options	Pages	Studio 500	Studio 1	Studio 2	Studio 3
Profil	10 to 11	✓	✓	✓	✓
Ceramica Wave	12 to 13	✗	✓	✓	✗
Edge / Edge 'Cool Wall'	14 to 15	✓	✓	✓	✓
Edge +	16 to 17	✓	✓	✓	✓
Glass	18 to 19	✓	✓	✓	✓
Steel	20 to 21	✓	✓	✓	✓
Verve	22 to 23	✓	✓	✓	✓
Bauhaus	24 to 25	✓	✓	✓	✓
Firenza	26 to 27	✗	✓	✓	✗
Pienza	26 to 27	✗	✓	✓	✗
Sienna	26 to 27	✗	✓	✓	✗
Sorrento	28 to 29	✓	✓	✓	✗
Bench (Steel & Glass frames)	30 to 31	✗	✓	✓	✓
Freestanding (complete product)	32 to 39	✓	✓	✓	✓



Riva Studio Edge



Riva Studio Edge +



Riva Studio Freestanding



Riva Studio Sorrento - Natural Limestone and Polished Black Granite







Riva Studio Profil



Riva Studio Bauhaus - Polished Stainless Steel



Riva Studio Bauhaus - Jet Black Metallic



Riva Studio Verve (horizontal curve)

(aerial view below)



Riva Studio Bench - Glass



Riva Studio Bench - Steel



Riva Studio Glass



Riva Studio Sienna



Riva Studio Firenze



Riva Studio Pienza



Riva Studio Steel



Riva Studio Ceramica Wave - Graphite



Riva Studio Ceramica Wave -  
Oyster White



Riva Studio Ceramica Wave -  
Oyster White & Graphite

# RIVA | STUDIO PROFIL



The Studio Profil features ultra contemporary styling that fits in perfectly with all modern interiors. Furthermore, the Studio Profil is finished in Jet Black Metallic and is available on all sizes of Riva Studio fires.

If you wish to add a splash of colour to your home, you can customise your Studio Profil with one of four additional colour finishes available in either Metallic Red, Metallic Blue, Metallic Bronze or Ivory. Please see pages 42 - 43 for further information.

In addition, by fitting the optional ducting system you can also heat up to two adjacent living spaces with your Riva Studio 500, 1 and 2 and up to four when you chose a Riva Studio 3.

Fire sizes	Studio 500	Studio 1	Studio 2	Studio 3
Heat outputs	5.0kW	5.0kW	8.0kW	11.0kW
Maximum log lengths	250mm (10")	300mm (12")	400mm (16")	500mm (20")
Frame dimensions mm (wxhxd)	646 x 517 x 33	839 x 517 x 33	1039 x 542 x 33	1426 x 547 x 45



**Left:**

Riva Studio 1 Profil.

**Right:**

Riva Studio 3 Profil shown with Cape Town Grey 60 x 30cm Fireplace Tile Surround.







# RIVA | STUDIO CERAMICA WAVE

The very latest in fire design. It is hard not to warm to the outstanding modern appeal of the Riva Studio Ceramica Wave. Specially designed for contemporary living, this stunning frame is available in a choice of three finishes for the Riva Studio 1 and 2.

Whether you opt for the dramatic all Graphite frame, the minimalist Oyster White frame or the contrasting Graphite and Oyster White frame, the Riva Studio Ceramica Wave will create an impressive focal feature - even when the fire is off.



**Left:**

Riva Studio 2 Ceramica Wave in Graphite.

**Right:**

Riva Studio 1 Ceramica Wave in  
Graphite & Oyster White.

Fire sizes	Studio 1	Studio 2
Heat outputs	5.0kW	8.0kW
Maximum log lengths	300mm (12")	400mm (16")
Frame dimensions mm (wxhxd)	1480 x 665 x 19	1880 x 690 x 19





# RIVA | STUDIO EDGE



The Riva Studio Edge is for those who require minimalist modern perfection. This contemporary fire has a seamless no-frame design, allowing your home's interior to frame and enhance the roaring flames. Combine this with the optional fan-assisted convection system and you can boost the flow of heat into your room whilst providing a beautiful focal point.

The Riva Studio 500 has been specifically designed to fit into a standard 22" British fireplace opening without any additional building work.

Please also see the Riva Studio 500 Edge pictured on page 45.

Fire sizes	Studio 500	Studio 1	Studio 2	Studio 3
Heat outputs	5.0kW	5.0kW	8.0kW	11.0kW
Maximum log lengths	250mm (10")	300mm (12")	400mm (16")	500mm (20")
Frame dimensions mm (wxhxd) Edge	696 x 567 x 34*	740 x 418 x 34*	940 x 443 x 34*	1327 x 448 x 44.5*
Frame dimensions mm (wxhxd) Edge 'Cool Wall'	700 x 578 x 59*	740 x 225 x 59*	940 x 450 x 59*	1327 x 460 x 70*

\* Once installed, Edge kits are flush with the finished wall surface. Edge 'Cool Wall' kits are recessed 28mm (Studio 500, 1 & 2) or 13mm (Studio 3) from the finished surface.

**Left:**

Riva Studio 2 Frameless Edge shown with Stovax Pretoria Anthracite Matt 60 x 30cm Fireplace Tile Surround.

**Right:**

Riva Studio 3 Frameless Edge 'Cool Wall'.





# RIVA | STUDIO EDGE +



New to the range and as a continuation from the Riva Studio Edge, the Edge + provides a similarly frameless 'hole in the wall' fire look, yet offers the additional benefit of a more simplified finishing process.

A slim profile decorative frame, crafted from 1mm thick steel, overlays the finished wall surface and provides a perfectly crisp finish around the installation opening.

With a complementary Matt Black finish, the Riva Studio Edge + is a sophisticated and functional styling option that simply lets the Riva Studio's impressive flame picture provide all the aesthetic appeal!

Fire sizes	Studio 500	Studio 1	Studio 2	Studio 3
Heat outputs	5.0kW	5.0kW	8.0kW	11.0kW
Maximum log lengths	250mm (10")	300mm (12")	400mm (16")	500mm (20")
Frame dimensions mm (wxhxd) Edge +	700 x 573 x 34*	893 x 573 x 34*	1073 x 598 x 34*	1480 x 603 x 34*

Once installed, the Edge kits are flush with the finished wall surface. Edge + kit includes decorative frame

\*Depth is adjustable between 32mm and 52mm between Edge + frame and kit when fitted

**Left:**

Riva Studio 1 Edge +.

**Right:**

Riva Studio 2 Edge +.











# RIVA | STUDIO GLASS

With its crisp lines and reflective surface, the Riva Studio Glass offers you a complete focal point around which to create your very own distinctive decorative style.

This sleek frame is available in all four Riva Studio sizes, giving you the versatility to match your personal design and heating needs.



**Left:**  
Riva Studio 1 Glass.  
Also shown - Small curved log holder  
also available from Stovax.

**Right:**  
Riva Studio 2 Glass.

Fire sizes	Studio 500	Studio 1	Studio 2	Studio 3
Heat outputs	5.0kW	5.0kW	8.0kW	11.0kW
Maximum log lengths	250mm (10")	300mm (12")	400mm (16")	500mm (20")
Frame dimensions mm (wxhxd)	1016 x 573 x 8	1209 x 573 x 8	1445 x 628 x 8	1932 x 653 x 8



# RIVA | STUDIO STEEL



The Riva Studio Steel is for those with large spaces who wish to create a greater presence with their choice of fireplace. Finished in Jet Black Metallic, the Studio Steel's wide frame instantly creates a distinctive and individual focal point that can be further matched to your interior space by choosing from the four sizes available.

For a splash of colour, the Riva Studio Steel can be customised with one of four additional colour frames in Metallic Red, Metallic Blue, Metallic Bronze or Ivory. For further information please see pages 42 - 43.

Fire sizes	Studio 500	Studio 1	Studio 2	Studio 3
Heat outputs	5.0kW	5.0kW	8.0kW	11.0kW
Maximum log lengths	250mm (10")	300mm (12")	400mm (16")	500mm (20")
Frame dimensions mm (wxhxd)	1010 x 567 x 3	1203 x 567 x 3	1439 x 622 x 3	1926 x 647 x 3



**Left:**

Riva Studio 2 Steel.

**Right:**

Riva Studio 3 Steel.

Also shown: Large Ironworks log holder  
& tool set also available from Stovax.







# RIVA | STUDIO VERVE

The Verve adds a curved 3D frame to the Riva Studio fire range. A statement frame to create a designer look, the Verve is finished in Jet Black Metallic and is available in all four Riva Studio sizes.

The Riva Studio Verve is also available with our selection of vibrant colour options; Metallic Red, Metallic Blue, Metallic Bronze or Ivory. For further information please see pages 42 - 43.



**Left:**  
Riva Studio 3 Verve.

**Right:**  
Riva Studio 2 Verve.

Fire sizes	Studio 500	Studio 1	Studio 2	Studio 3
Heat outputs	5.0kW	5.0kW	8.0kW	11.0kW
Maximum log lengths	250mm (10")	300mm (12")	400mm (16")	500mm (20")
Frame dimensions mm (wxhxd)	1010 x 567 x 40	1203 x 567 x 48	1440 x 622 x 59	1927 x 674 x 83







# RIVA | STUDIO BAUHAUS

The Riva Studio Bauhaus is a classic three dimensional tapered frame. This frame comes in two finishes and is offered on all sizes of Riva Studio fires, enabling you to perfectly match the Bauhaus to whatever the size and style of your room. Whether you opt for the contemporary Polished Stainless Steel or the refined lines of the Jet Black Metallic finish, the Bauhaus will heat your home in flawless style.

The Riva Studio Bauhaus is available with a choice of four vibrant colour options to further customise your choice of fire. Please see pages 42 - 43 for further information.



**Left:**  
Studio 3 Bauhaus  
in Polished Stainless Steel.

**Right:**  
Studio 2 Bauhaus  
in Jet Black Metallic.  
Also shown - Medium log holder also  
available from Stovax.

Fire sizes	Studio 500	Studio 1	Studio 2	Studio 3
Heat outputs	5.0kW	5.0kW	8.0kW	11.0kW
Maximum log lengths	250mm (10")	300mm (12")	400mm (16")	500mm (20")
Frame dimensions mm (wxhxd)	657 x 528 x 36	850 x 526 x 49	1050 x 554 x 49	1437 x 559 x 49



# RIVA | STUDIO FIRENZA, PIENZA & SIENNA



The Riva Studio stone frames offer three stylish natural options to complement your Studio fire. This range has been created to add maximum visual impact, blending the subtle textures and delicate tones of natural stone with the very latest in fireplace design, offering a solid quality to expertly contrast with the fluid motion of the rolling flames.

Whether it's the polished black granite Firenze, the timeless limestone Pienza or the stylish travertine Sienna, your choice from this stunning collection will add that look of undeniable elegance to your interior that is only achieved by using solid stone.

Available for either the Riva Studio 1 or 2, and at home in both contemporary and modern interiors, these precision-cut, stunning frames offer the ultimate in design perfection. Style has never been so effortless.



Fire sizes	Studio 1	Studio 2
Heat outputs	5.0kW	8.0kW
Maximum log lengths	300mm (12")	400mm (16")
Frame dimensions mm (wxhxd)	1480 x 597 x 18	1720 x 621 x 18











# RIVA | STUDIO SORRENTO

If you wish to hearth mount your Riva Studio then the graceful Sorrento presents the perfect solution. Crafted from either elegant limestone or striking polished black granite, the addition of this surround offers a designer focal point around which to create your own individual decorative style.

Available for either the Riva Studio 500, 1 or 2, the solid stone Sorrento is the perfect enhancement to the already impressive Riva Studio fire, ensuring that your fireplace remains at the heart of your home - even when it isn't burning!

The Riva Studio 500 Sorrento (shown below) is available in Polished Black Granite only and has matching granite panels on either side of the fire that are recessed from the outer frame.



Fire sizes	Studio 500	Studio 1	Studio 2
Heat outputs	5.0kW	5.0kW	8.0kW
Maximum log lengths	250mm (10")	300mm (12")	400mm (16")
Frame dimensions mm (wxhxd)	1338 x 678 x 300	1338 x 678 x 300	1536 x 703 x 300



**Above:**

Riva Studio 1 Sorrento  
in Polished Black Granite.

**Left:**

Riva Studio 2 Sorrento  
in Natural Limestone.



# RIVA | STUDIO BENCH - GLASS & STEEL FRAMES

The new Bench frame models, allow the same ultra-contemporary styling of the cassette Glass and Steel frames to be brought out into the room, creating extra impact for larger rooms and an impressive designer statement.

Using a special frame to encase your Riva Studio 1, 2 or 3 cassette fire and by incorporating one of Stovax's unique Riva Benches in either high or low options, the Bench Glass and Bench Steel become impressive stand alone fires.

## Riva Bench required

	Low	High
Riva Bench 100	RVACLB100B	RVACB100B
Riva Bench 120	RVACLB120B	RVACB120B
Riva Bench 140*	RVACLB140B	RVACB140B

\*The Riva Studio 3 is only compatible with the 140 Low & High benches

## Frame required (includes casing)

	Steel	Glass
Riva Studio 1	RVBS-1FST	RVBS-1FGB
Riva Studio 2	RVBS-2FST	RVBS-2FGB
Riva Studio 3	RVBS-3FST	RVBS-3FGB

## Additional options

Black glass top plate (Studio 1)	RVBS-1BG
Black glass top plate (Studio 2)	RVBS-2BG
Black glass top plate (Studio 3)	RVBS-3BG
Decorative square section flue cover ♦	RVFS-SFCO
Smoke Control Kit (Studio 1)	RVS-1SCKIT
Smoke Control Kit (Studio 2)	RVS-2SCKIT

♦ 215 x 1800 x 212mm (w x h x d)



Fire sizes	Studio 1	Studio 2	Studio 3*
Heat outputs	5.0kW	8.0kW	11.0kW
Maximum log lengths	300mm (12")	400mm (16")	500mm (20")

**Above:**

Riva Studio 2 Bench Steel with 120 High Bench and decorative square section flue cover.

Also shown - Contemporary bevelled tool set also available from Stovax.

For full technical specifications and dimensions, please refer to pages 40 & 42







# RIVA | STUDIO 500 FREESTANDING

The Studio 500 Freestanding is a new addition to the range, further extending and complementing the already impressive choice of Riva Studio fires available. This high performing fire has a compact, yet innovative design, broadening the Riva Studio's versatility and suitability to a variety of homes.

With a heat output to match that of the Studio 1, the 500 will provide ambiance and warmth to a cosy inglenook. It can also be teamed with a number of optional extras including the black glass top plate for a sleek and shining finish. The 500 can also be placed on one of our Riva Benches to create a real style statement - see page 44 for further details.

## Additional options

Black glass top plate .....	RVFS-500GB
Decorative black flue ring cover .....	RVAC220B
Decorative square section flue cover ♦ .....	RVFS-SFCO
Smoke Control Kit† .....	RVS-500SCKIT
Heat Shield kit* .....	RVFS-500HSK
Riva Bench 100 Low .....	RVACLB100B
Riva Bench 100 High .....	RVACB100B
Riva Bench 120 Low .....	RVACLB120B
Riva Bench 120 High .....	RVACB120B
Riva Bench 140 Low .....	RVACLB140B
Riva Bench 140 High .....	RVACB140B
Riva Bench 180 Low .....	RVACLB180B
Riva Bench 180 High .....	RVACB180B

♦ 215 x 1800 x 212mm (w x h x d)

\* Available when fitted to a Riva Bench † Subject to official listing



Fire size	Studio 500
Heat output	5.0kW
Maximum log length	250mm (10")
Box dimensions mm (wxhxd)	607 x 479 x 382



**Left:**

Riva Studio 500 Freestanding.

**Right:**

Riva Studio 500 Freestanding  
on a 100 Low Riva Bench.  
Also shown: Medium log holder  
also available from Stovax.

# RIVA | STUDIO 1 FREESTANDING



Fire size	<b>Studio 1</b>
Heat output	5.0kW
Maximum log length	300mm (12")
Box dimensions mm (wxhxd)	800 x 479 x 380

#### Above:

Studio 1 Freestanding with black glass top plate  
and decorative square section flue cover.

#### Right:

Studio 1 Freestanding on 120 Low Bench with  
black glass top plate and gloss black enamelled flue pipe.

The next size up in our Riva Studio Freestanding range, the Studio 1 incorporates the impressive firebox performance of a cassette fire with the welcoming presence of a stove. Available with a number of optional extras to help you create the right look for your home, the Riva Studio 1 Freestanding can be hearth mounted or installed on a Riva Bench. An optional heat shield kit can be fitted to the bench in order to reduce the distance to combustible materials if required.

Other styling options include a black glass top plate, gloss black enamel flue pipe, square section flue covers and flue ring covers, all of which are designed to provide an integrated and cohesive look to your new fire.

#### Additional options

Black glass top plate .....	RVFS-1GB
Decorative black flue ring cover .....	RVAC220B
Decorative square section flue cover* .....	RVFS-SFCO
Smoke Control Kit .....	RVS-1SCKIT
Heat Shield kit† .....	RVFS-1HSK
Riva Bench 100 Low .....	RVACLB100B
Riva Bench 100 High .....	RVACB100B
Riva Bench 120 Low .....	RVACLB120B
Riva Bench 120 High .....	RVACB120B
Riva Bench 140 Low .....	RVACLB140B
Riva Bench 140 High .....	RVACB140B
Riva Bench 180 Low .....	RVACLB180B
Riva Bench 180 High .....	RVACB180B

\*215 x 1800 x 212mm (w x h x d)

†Available when fitted to a Riva Bench









# RIVA | STUDIO 2 FREESTANDING

This Freestanding version of the Riva Studio 2 offers you up to 8kW of heating capacity as well as superb views of the flames. Featuring exactly the same firebox attributes as other Riva Studios, the Freestanding version may be mounted on a hearth or installed onto your choice of six optional Riva Benches.

You can also specify options such as a black glass top plate, gloss black enamel flue pipe, and square section flue cover to create your own bespoke look.

An optional heat shield kit can be fitted to the bench in order to reduce the distance to combustible materials if required.

## Additional options

Black glass top plate .....	RVFS-2GB
Decorative black flue ring cover .....	RVAC220B
Decorative square section flue cover* .....	RVFS-SFCO
Smoke Control Kit .....	RVS-2SCKIT
Heat Shield kit† .....	RVFS-2HSK
Riva Bench 120 Low .....	RVACLB120B
Riva Bench 120 High .....	RVACB120B
Riva Bench 140 Low .....	RVACLB140B
Riva Bench 140 High .....	RVACB140B
Riva Bench 180 Low .....	RVACLB180B
Riva Bench 180 High .....	RVACB180B

\*215 x 1800 x 212mm (w x h x d)

†Available when fitted to a Riva Bench



Fire size	Studio 2
Heat output	8.0kW
Maximum log length	400mm (16")
Box dimensions mm (wxhxd)	1000 x 504 x 380



## Above:

Studio 2 Freestanding on 140 Low Bench with gloss black enamelled flue pipe.

## Left:

Studio 2 Freestanding with black glass top plate and decorative square section flue cover. Also shown: Ironworks Loop tool set also available from Stovax.

# RIVA | STUDIO 3 FREESTANDING



Fire size	<b>Studio 3</b>
Heat output	11.0kW
Maximum log length	500mm (20")
Box dimensions mm (wxhxd)	1389 x 516 x 445

#### Above:

Riva Studio 3 Freestanding  
shown with decorative black flue ring cover.

#### Right:

Riva Studio 3 Freestanding on Riva 180 High Bench  
shown with decorative black flue ring cover.

The largest in the range is the striking Riva Studio 3 Freestanding. This highly efficient and visually impressive fire has the same 11kW of heat output and stunning widescreen views of the flames as its cassette equivalent but offers a very different look.

Designed to be sited on to the optional Riva 180 Bench, or hearth mounted to achieve the distinctive stove look, the Studio 3 Freestanding will create maximum visual impact in rooms of larger proportions. It also has the ability to be fitted with an optional rear heat shield to reduce the distance to combustible materials behind the appliance and extend the styling possibilities further still.

#### Additional options

Black glass top plate .....	RVFS-3GB
Decorative black flue ring cover .....	RVAC220B
Decorative square section flue cover* .....	RVFS-SFCO
Heat Shield kit† .....	RVFS-3HSK
Riva Bench 180 Low .....	RVACLB180B
Riva Bench 180 High .....	RVACB180B

\*215 x 1800 x 212mm (w x h x d) †Available when fitted to a Riva Bench





# RIVA STUDIO | INFORMATION

A HETAS approved installer should undertake a site survey prior to purchase and must install your Riva Studio for you. Your Stovax retailer will be able to offer advice on this. You may also view or download complete installation instructions from our website – [www.stovax.com](http://www.stovax.com). The diagrams on these pages cover some of the basic requirements and are for initial information purposes only.

## CASSETTE

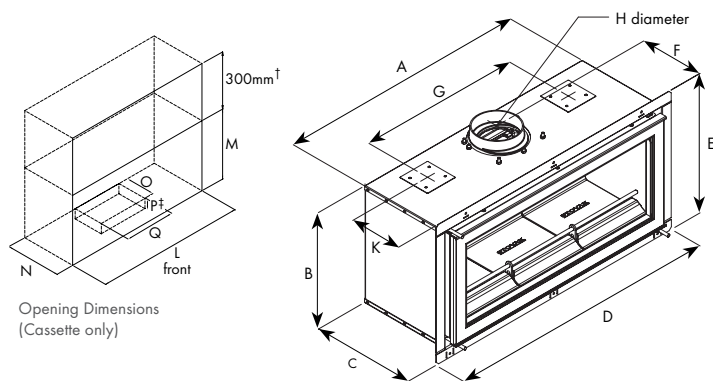

## FREESTANDING

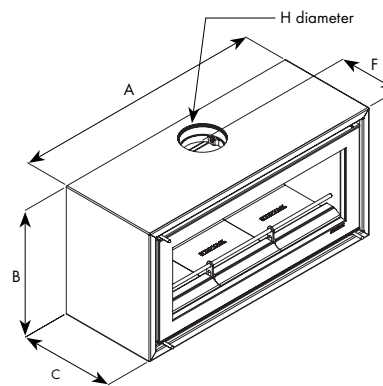

## BENCH - STEEL & GLASS FRAMES

INCORPORATING  
CASSETTE FIRES

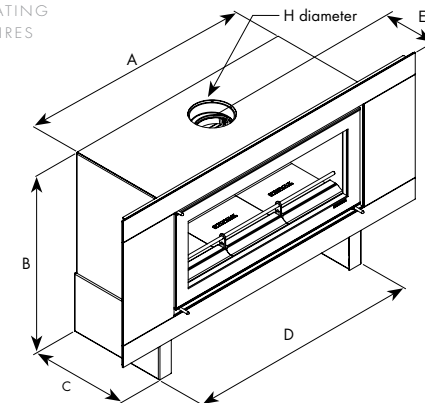

### CASSETTE DIMENSIONS

(all dimensions  
in mm)

	Studio 500	Studio 1	Studio 2	Studio 3	Studio 500 FS	Studio 1 FS	Studio 2 FS	Studio 3 FS
A	552	745	950	1332	607	800	1000	1389
B	415	415	440	450	479	479	504	516
C	350	350	350	393	382	380	380	445
D	628	821	1019	1406	-	-	-	-
E	497	497	522	532	-	-	-	-
F	246	246	246	291	260	260	260	325
G	380	480	610	610/1010*	-	-	-	-
H Ø	153	153	153	153	153	153	153	153
K	240	240	240	275	-	-	-	-
L	562	755	960	1342	-	-	-	-
M	435	435	460	470	-	-	-	-
N	355	355	355	405	-	-	-	-
O	100	100	115	115	-	-	-	-
P	25	25	25	25	-	-	-	-
Q	365	605	750	750	-	-	-	-
Window <sup>A</sup>	397 x 263	590 x 263	790 x 289	1177 x 286	397 x 263	590 x 263	790 x 289	1177 x 286
Weight	85Kg	76Kg	83Kg	120Kg	85Kg	100Kg	120Kg	192Kg

### FREESTANDING DIMENSIONS \*\*

### BENCH DIMENSIONS WITH BENCH CASING ♦

	Studio 1	Studio 2	Studio 3
A	800	1000	1400
B	735/835	766/866	770/870
C	420	420	420
D	1000	1000	1400
E	246	246	291
H	153	153	153

For Bench frame dimensions, please see page 42

### RIVA STUDIO FIRE INFORMATION

Product Code	Description	Heat Output	Fuel Type	Efficiency
RVS-500	Riva Studio 500	5.0kW	Wood	80%
RVS-1	Riva Studio 1	5.0kW	Wood	75%
RVS-2	Riva Studio 2	8.0kW	Wood	75%
RVS-3	Riva Studio 3	11.0kW	Wood	75%
RVFS-500	Riva Studio 500 Freestanding	5.0kW	Wood	80%
RVFS-1	Riva Studio 1 Freestanding	5.0kW	Wood	75%
RVFS-2	Riva Studio 2 Freestanding	8.0kW	Wood	75%
RVFS-3	Riva Studio 3 Freestanding	11.0kW	Wood	76%

† Extra height required when fitting Warm Air Ducting kit. ‡ If a fan kit is required, please allow 250mm for fitting.

\* Studio 500 1 & 2 models have two air duct outlets whilst Studio 3 models have four. Δ Flame viewing window.

Please refer to installation manual for minimum distances to combustible materials.

\*\* For complementary benches to go with the Freestanding models, please see information

provided on page 44.

♦ Please note that the Bench casing is required to fit a Glass or Steel frame to a Bench model, and is included with the frame codes on page 42.



# FRAME | INFORMATION

## RIVA STUDIO 500 CASSETTE (all dimensions in mm)

Product Code	Description	Width	Height	Depth
RVS-500PRO4	Profil <sup>°</sup>	646	517	33
RVS-500FST	Steel <sup>°</sup>	1010	567	3
RVS-500FGB	Glass <sup>°</sup>	1016	573	8
RVS-500FV	Verve	1010	567	48
RVS-500FB	Bauhaus Jet Black Metallic	657	528	49
RVS-500FBP	Bauhaus Polished Stainless Steel	657	528	49
RVS-500FSPG	Sorrento Polished Black Granite	1338	678	300
<b>Options</b>				
RVS-500FEK	Edge Kit	696	567	34*
RVS-500FCWK	Edge 'Cool Wall' Kit	700	578	59**
RVS-500	Edge + Kit†	700	573	34**

## RIVA STUDIO 1 CASSETTE (all dimensions in mm)

Product Code	Description	Width	Height	Depth
RVS-1FPRO4	Profil <sup>°</sup>	839	517	33
RVS-1FST	Steel <sup>°</sup>	1203	567	3
RVS-1FGB	Glass <sup>°</sup>	1209	573	8
RVS-1FCWG	Ceramica Wave <sup>°</sup> Graphite	1480	665	19
RVS-1FCWW	Ceramica Wave <sup>°</sup> Oyster White	1480	665	19
RVS-1FCWGW	Ceramica Wave <sup>°</sup> Graphite & Oyster White	1480	665	19
RVS-1FV	Verve	1203	567	48
RVS-1FB	Bauhaus Jet Black Metallic	850	526	49
RVS-1FBP	Bauhaus Polished Stainless Steel	850	526	49
RVS-1FFR	Firenza	1480	597	18
RVS-1FPZ	Pienza	1480	597	18
RVS-1FSN	Sienna	1480	597	18
RVS-1FSNL	Sorrento Natural Limestone	1338	678	300
RVS-1FSPG	Sorrento Polished Black Granite	1338	678	300
<b>Options</b>				
RVS-1FEK	Edge Kit	889	567	34*
RVS-1FCWK	Edge 'Cool Wall' Kit	893	578	59**
RVS-1	Edge + Kit†	893	573	34**

## RIVA STUDIO 2 CASSETTE (all dimensions in mm)

Product Code	Description	Width	Height	Depth
RVS-2FPRO4	Profil <sup>°</sup>	1039	542	33
RVS-2FST	Steel <sup>°</sup>	1439	622	3
RVS-2FGB	Glass <sup>°</sup>	1445	628	8
RVS-2FCWG	Ceramica Wave <sup>°</sup> Graphite	1880	690	19
RVS-2FCWW	Ceramica Wave <sup>°</sup> Oyster White	1880	690	19
RVS-2FCWGW	Ceramica Wave <sup>°</sup> Graphite & Oyster White	1880	690	19
RVS-2FV	Verve	1440	622	59
RVS-2FB	Bauhaus Jet Black Metallic	1050	554	49
RVS-2FBP	Bauhaus Polished Stainless Steel	1050	554	49
RVS-2FFR	Firenza	1720	621	18
RVS-2FPZ	Pienza	1720	621	18
RVS-2FSN	Sienna	1720	621	18
RVS-2FSNL	Sorrento Natural Limestone	1536	703	300
RVS-2FSPG	Sorrento Polished Black Granite	1536	703	300
<b>Options</b>				
RVS-2FEK	Edge Kit	1089	592	34*
RVS-2FCWK	Edge 'Cool Wall' Kit	1093	603	59**
RVS-2	Edge + Kit†	1073	598	34**

## RIVA STUDIO 3 CASSETTE (all dimensions in mm)

Product Code	Description	Width	Height	Depth
RVS-3FPRO4	Profil <sup>°</sup>	1426	547	45
RVS-3FST	Steel <sup>°</sup>	1926	647	3
RVS-3FGB	Glass <sup>°</sup>	1932	653	8
RVS-3FV	Verve	1927	674	83
RVS-3FB	Bauhaus Jet Black Metallic	1437	559	49
RVS-3FBP	Bauhaus Polished Stainless Steel	1437	559	49
<b>Options</b>				
RVS-3FEK	Edge Kit	1476	597	44.5*
RVS-3FCWK	Edge 'Cool Wall' Kit	1480	613	70**
RVS-3	Edge + Kit†	1480	603	34**

† The Edge + kit is a complete kit including the decorative frame and has no requirement for, nor is compatible with, any other Edge or Cool Wall kits. \*\* Once installed, Edge 'Cool Wall' Kits are recessed 28mm (Studio 1 & 2) or 13mm (Studio 3) from the finished surface.

\* Once installed, Edge Kits are flush with the finished wall surface. # Depth is adjustable between 32mm and 52mm between Edge + frame and kit when fitted. ° Registered European Designs 001169338\_0001/8

# FRAME | INFORMATION

## RIVA STUDIO 1, 2 & 3 BENCH WITH STEEL OR GLASS FRAME *(all dimensions in mm)*

Product Code	Description	Width*	Height*	Depth*
RVBS-1FST	Studio 1 Bench Steel <sup>◊</sup>	1203	567	3
RVBS-1FGB	Studio 1 Bench Glass <sup>◊</sup>	1209	573	8
RVBS-2FST	Studio 2 Bench Steel <sup>◊</sup>	1439	622	3
RVBS-2FGB	Studio 2 Bench Glass <sup>◊</sup>	1445	628	8
RVBS-3FST	Studio 3 Bench Steel <sup>◊</sup>	1926	647	3
RVBS-3FGB	Studio 3 Bench Glass <sup>◊</sup>	1932	653	8

<sup>◊</sup> Registered European Designs 001169338\_0001/8

\* Dimensions are for the frame only. For total dimensions including the cassette and bench casing, please refer to information provided on page 40

Right: Riva Studio 3 Bench Steel



## Coloured Frame Options

To add a splash of colour to your cassette fire, Stovax is pleased to offer a choice of vibrant finishes on selected Riva Studio frames. The four eye catching colour finishes are Metallic Bronze, Metallic Blue, Metallic Red and Ivory and are available for the Profil, Steel, Verve and Bauhaus frame options for a thoroughly striking look.



Look for the Colour Frame Choices Logo on available frames throughout this brochure. When ordering, please use the following suffix for your chosen colour:

- Metallic Red (RD)
- Metallic Blue (BL)
- Metallic Bronze (BZ)
- Ivory (IV)



Metallic Red



Metallic Blue



Metallic Bronze



Ivory



Riva Studio 1  
Profil in Ivory



Riva Studio 2 Steel  
in Metallic Bronze



# FURTHER | INFORMATION

## Riva Benches

These stunning benches, compatible with the Riva Studio Freestanding 500, 1, 2 & 3\* and required for all Riva Studio Bench frame models, offer infinitely greater design possibilities. With four widths and two heights to choose from, you can be sure to satisfy your individual styling requirements.

- Sturdy steel construction
- Choice of 4 widths & 2 heights
- Durable matching black finish
- Proportioned 60mm wide legs
- Allows for central or offset stove positioning
- High: 1000/1200/1400/1800 x 350 x 420/465†mm (w x h x d)
- Low: 1000/1200/1400/1800 x 250 x 420/465†mm (w x h x d)

\* Riva Studio 3 Freestanding fires may be mounted onto a Riva 180 Bench only. † Riva 180 Bench only.



## Riva Studio Heat Shields

Stovax has introduced a range of highly effective Heat Shields for the Riva Studio Freestanding range. Available for all sizes of Freestanding models: Studio 500, 1, 2 and 3, and only when fitted to a Riva Bench, these fantastic additions allow a reduction of up to 85% in the distance to combustible materials at the rear of the appliance – reducing this to just 75mm.

The Riva Studio Heat Shields not only maximise the available space within the room, but they also enable you to accommodate a wider range of materials in your interior design.

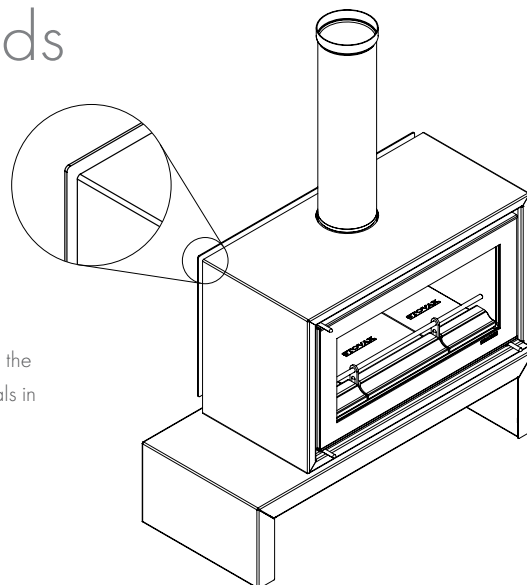

Riva Studio 1 Freestanding on 120 Low Bench



# Edge and Cool Wall Kits

## Edge/Edge + Kit (*cassette fires only*)

This kit is screw-mounted to the front flange of the outer firebox. The L-shaped attachments provide a 34/44.5mm† return against which high temperature plasterboard/screed can be butted up for the ‘clean edge’ look. The Edge Kit is made in aluminised steel which can then be painted to match the decor of your room. The Edge + has a decorative slim frame that fits over the finished installation opening.

## Cool Wall Kit (*cassette fires only*)

Again, screw-mounted to the front flange of the outer firebox, the U-shaped attachments of the Cool Wall Kit are designed primarily for studwork or false chimney breasts. The additional depth allows some of the heat to be vented up into the void above the firebox and then re-enter the room at a higher level. The effect is to produce a cooler wall immediately above the appliance than would otherwise be the case. The Cool Wall Kit is made in aluminised steel which can then be painted to match the decor of your room.

† 34mm Studio 500, 1 & 2 / 44.5mm Studio 3

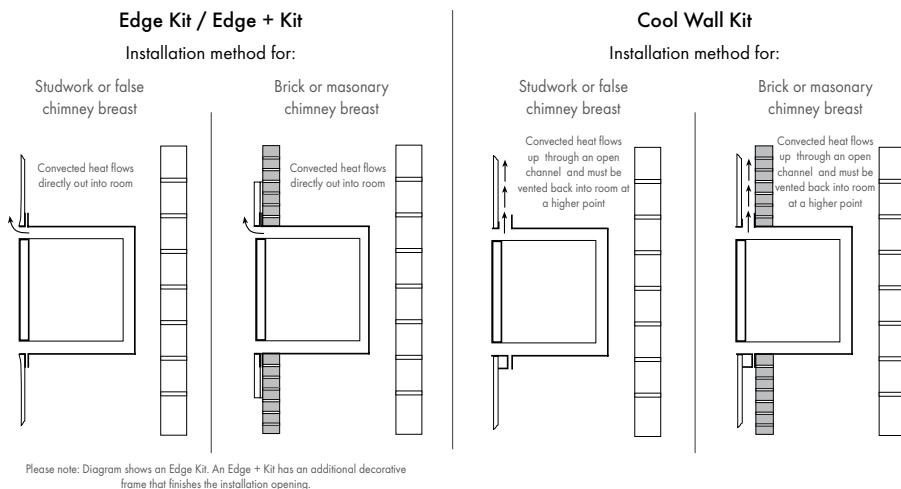

NB: When using the Edge Kit and Edge + Kit, heat resistant board and high temperature finishing plaster must be used. Please refer to installation instructions for full details of both kits which can be downloaded from [www.stovax.com](http://www.stovax.com)



Riva Studio 500 Edge with Victorian Corbel mantel in antique white marble.

# FURTHER | INFORMATION

## Riva Studio Visualiser iPad App

The Stovax Riva Studio Visualiser gives you a visual concept of having a real woodburning fire in your room. Intuitive, convenient and easy to use, the Riva Studio Visualiser enables you to view all fires in the Stovax Riva Studio range against a photo of your room or within a pre-loaded professional set to give you plenty of ideas and inspiration!

The Stovax Riva Studio Visualiser helps you choose the right fire and frame option, as well as the perfect location in your room. You can take your own room photos from within the application or use our pre-loaded inspirational room designs onto which you can view and select your favourite Riva Studio woodburning fire from the range. When you're happy with the result, simply capture the final image, which automatically saves to your Camera Roll on your device. The app is free and available to download from the App Store direct to your iPad now.

The Riva Studio Visualiser app is designed to enable you to:

- take a photo with the built-in camera on your device
- use any of the pre-loaded inspirational room sets
- use any existing photo in your photo library
- choose from the very latest woodburning Riva Studio Cassette, Freestanding & Bench Mounted Fires
- swipe screen to easily change your fire choice
- pinch, zoom & drag your chosen fire to approximately scale the fire to the room\*
- save the completed design to your Camera Roll
- find your local retailer (internet connection required)

\* The fires in this Application are not representative of their actual size.

Please note: the Stovax Riva Studio Visualiser is to be used as an interior design aid only and by no means should be used to base your purchase and installation decisions upon.



To view the Riva Studio Visualiser app page and to download the app, simply scan this code

## Warm Air Ducting kit

The kit, for the cassettes only, which includes two 3 metre lengths of flexible ducting, allows you to heat up to two other living spaces. The Riva Studio 3 has four ports so you can even add two kits if required, providing heat for up to four additional rooms.

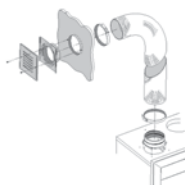

## 10° Angled Flue Outlet

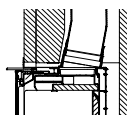

This optional flue outlet for the Riva Studio Cassettes offers greater installation flexibility and ease, especially in larger openings with deeper lintels.

## Warranty & Safety Details

When you choose a Stovax Riva Studio cassette or freestanding fire, quality and technology are assured. Accordingly, your Stovax retailer will provide you with a Two Year Warranty for your new Riva Studio cassette or freestanding fire. Full details of this warranty are available to view at [www.stovax.com](http://www.stovax.com).



Stovax pursue a policy of continuous product improvement, therefore, whilst our products are correct at the time of the photography, we reserve the right to make alterations and amendments. Exact product details should be discussed with your retailer at the time of purchase. All fire and flame photography has been taken from genuine products, however, the exact appearance of the flame picture for any appliance will vary depending on the nature of the flue type, installation surroundings, local geographical features and the way in which the appliance is operated.

Please note that all parts of these fires, particularly the glass panel in the door, become extremely hot during operation and can result in serious injury and burns if touched. It is therefore recommended that a fireguard complying with BS 8423:2002 is used in the presence of young children, the elderly or infirm.



## Care of your Riva Studio Fire



To help you get the best performance from your Riva Studio fire and keep it in good condition, inside and out, Stovax offers a wide variety of cleaning and maintenance products. Stovax also supplies an extensive range of fireplace accessories, including contemporary tool sets and log holders, about which your Stovax retailer will be able to give you full details. Alternatively, you can view the complete range by visiting [www.stovax.com](http://www.stovax.com) or by simply scanning the code above.

## Professional XQ™ Chimney Systems & Enamelled Flue Pipe

Stovax also offers a comprehensive range of stove and fireplace chimney systems: the Stovax Professional XQ™ collection. Crafted from 304L grade stainless steel for a durable outer finish, the fully sealed components offer water tight protection for the insulation within.



With innovative decorative options, the ability to specify a colour for your system and with a host of technical advancements such as their Twist-Lock system, the Professional XQ™ range provides an attractive, versatile and reliable solution for your flue system. Furthermore, the Professional XQ™ range carries a 10 year conditional warranty offering complete peace of mind. For further information or to request a brochure, simply contact your local retailer or visit [www.stovax.com/chimneysystems](http://www.stovax.com/chimneysystems).





Riva Studio 3 Frameless Edge shown with Kappa 67.1 x 33.3 Fireplace Tile Surround

**STOVAX**  
Fire Your Imagination

Stovax Limited, Falcon Road, Sowton Industrial Estate, Exeter, Devon, England EX2 7LF

**Trade Sales** Tel: 01392 474000

Fax: 01392 219932

**Export Sales** Tel: +44 1392 261990

Email: [info@stovax.com](mailto:info@stovax.com)

**Other depts** Tel: 01392 474011

[www.stovax.com](http://www.stovax.com)

A member of the Stovax Group

Stovax gratefully acknowledges the assistance of the following companies with photographic settings:

John Lewis - [www.johnlewis.com](http://www.johnlewis.com) Original Style - [www.originalstyle.com](http://www.originalstyle.com) Debenhams - [www.debenhams.co.uk](http://www.debenhams.co.uk)  
Furniture Village - [www.furniturevillage.com](http://www.furniturevillage.com) Habitat - [www.habitat.co.uk](http://www.habitat.co.uk) Amos Lighting - [www.amoslighting.co.uk](http://www.amoslighting.co.uk)  
House of Fraser - [www.houseoffraser.co.uk](http://www.houseoffraser.co.uk) Orange Tree - [www.theorangeretree.co.uk](http://www.theorangeretree.co.uk)

To view & download our complete range of brochures, simply scan this code or visit [www.stovax.com](http://www.stovax.com)



Your Stovax stockist:

£2.00



RSTUDIO

